

# RECORD OF SURVEY

ALL OF LOT 526, OAKRIDGE PARK PHASE 5, LOCATED IN THE NORTHEAST QUARTER OF SECTION 34, T2S, R2W SLB&M, SALT LAKE COUNTY, UTAH

## NARRATIVE

THIS SURVEY WAS PREPARED TO REESTABLISH THE PROPERTY CORNERS OF THE PARCEL BOUNDARY, SURROUNDING SURVEYS, PLAT MAPS AND FOUND MONUMENTS WERE USED TO ESTABLISH THE PROPERTY BOUNDARY AS WELL AS BASIS OF BEARINGS.

THE BASIS OF BEARING FOR THIS SURVEY IS BASED ON THE ROAD CENTERLINE AT THE INTERSECTION OF 6780 W AND 8160 S, WHENCE A FOUND FLAT BRASS MONUMENT AT THE INTERSECTION OF 6780 W 8100 S BEARS NORTH 00°00'34" EAST A DISTANCE OF 220.99 FEET.

THE PROPERTY LINE WAS ESTABLISHED BASED ON THE OAKRIDGE PARK PHASE 5 PLAT.

SIX FOUND OFFSETS WERE USED TO SET THE BOUNDARY. SIX STREET MONUMENTS ALONG WITH THE FOUND OFFSETS WERE USED AS WELL TO POSITION THE BOUNDARY.

THE MARKERS SET ARE SHOWN HEREON.

## NOTES

1. ALL DIMENSIONS SHOWN ARE IN US SURVEY FEET AND DECIMALS THEREOF.

2. THIS SURVEY DOES NOT CONSTITUTE A TITLE SEARCH BY VARA 3D. ALL INFORMATION REGARDING RECORD EASEMENTS, BOUNDARIES, ADJOINERS AND OTHER DOCUMENTS THAT MIGHT AFFECT THE QUALITY OF TITLE TO TRACT SHOWN HEREON CAN BE OBTAINED FROM THE COUNTY OFFICES. THIS DRAWING DOES NOT GUARANTEE THE EXISTENCE OR ABSENCE OF ADDITIONAL EASEMENTS OR BOUNDARIES WITHIN THE PROJECT AREA.

## LEGAL DESCRIPTION:

ALL OF LOT 526, OAKRIDGE PARK PHASE 5, LOCATED IN THE NORTHEAST QUARTER OF SECTION 34, TOWNSHIP 2 SOUTH, RANGE 2 WEST OF THE SALT LAKE BASE & MERIDIAN, SALT LAKE COUNTY, AND BEING MORE PARTICULARLY DESCRIBED AS FOLLOWS:

COMMENCING AT A FOUND FLAT BRASS MONUMENT AT THE INTERSECTION OF 6780 W AND 8160 S, WHENCE A FOUND FLAT BRASS MONUMENT AT THE INTERSECTION OF 6780 W 8100 S BEARS NORTH 00°00'34" EAST A DISTANCE OF 220.99 FEET, SAID LINE FORMING THE BASIS OF BEARING FOR THIS DESCRIPTION;

THENCE NORTH 00°00'34" EAST ALONG SAID LINE A DISTANCE OF 110.00 FEET;  
THENCE SOUTH 89°59'26" EAST A DISTANCE OF 25.00 FEET TO THE POINT OF BEGINNING;

THENCE NORTH 00°00'34" EAST A DISTANCE OF 75.00 FEET;  
THENCE SOUTH 89°59'26" EAST A DISTANCE OF 115.00 FEET;  
THENCE SOUTH 00°00'34" WEST A DISTANCE OF 75.00 FEET;  
THENCE NORTH 89°59'26" WEST A DISTANCE OF 115.00 FEET TO THE POINT OF BEGINNING.

SAID PARCEL CONTAINS 8,625 SQ. FT. OR 0.198 ACRES.

## SURVEYOR'S CERTIFICATE

I, JAMES V. HEINRITZ, A LICENSED PROFESSIONAL LAND SURVEYOR IN THE STATE OF UTAH, LICENSE NO. 11072412-2201, DO HEREBY CERTIFY THAT THIS MAP CORRECTLY REPRESENTS A SURVEY MADE BY ME, OR UNDER MY DIRECT SUPERVISION, OF THE HEREON DESCRIBED PROPERTY AND THAT TO THE BEST OF MY KNOWLEDGE IT IS A CORRECT REPRESENTATION OF THE LAND SURVEYED.

# PRELIMINARY

JAMES V. HEINRITZ, PLS 11072412-2201  
FOR AND ON BEHALF OF VARA 3D, INC.

## LEGEND:

	BOUNDARY LINE
	NEIGHBOR BOUNDARY LINE
	SET LOT CORNERS WITH 5/8" REBAR AND CAP STAMPED VARA 3D UNLESS OTHERWISE NOTED
	FOUND MONUMENT AS NOTED
	PANORAMIC PHOTO LOCATION
	SIGN
	UNDERGROUND GAS LINE
	UNDERGROUND WATER LINE

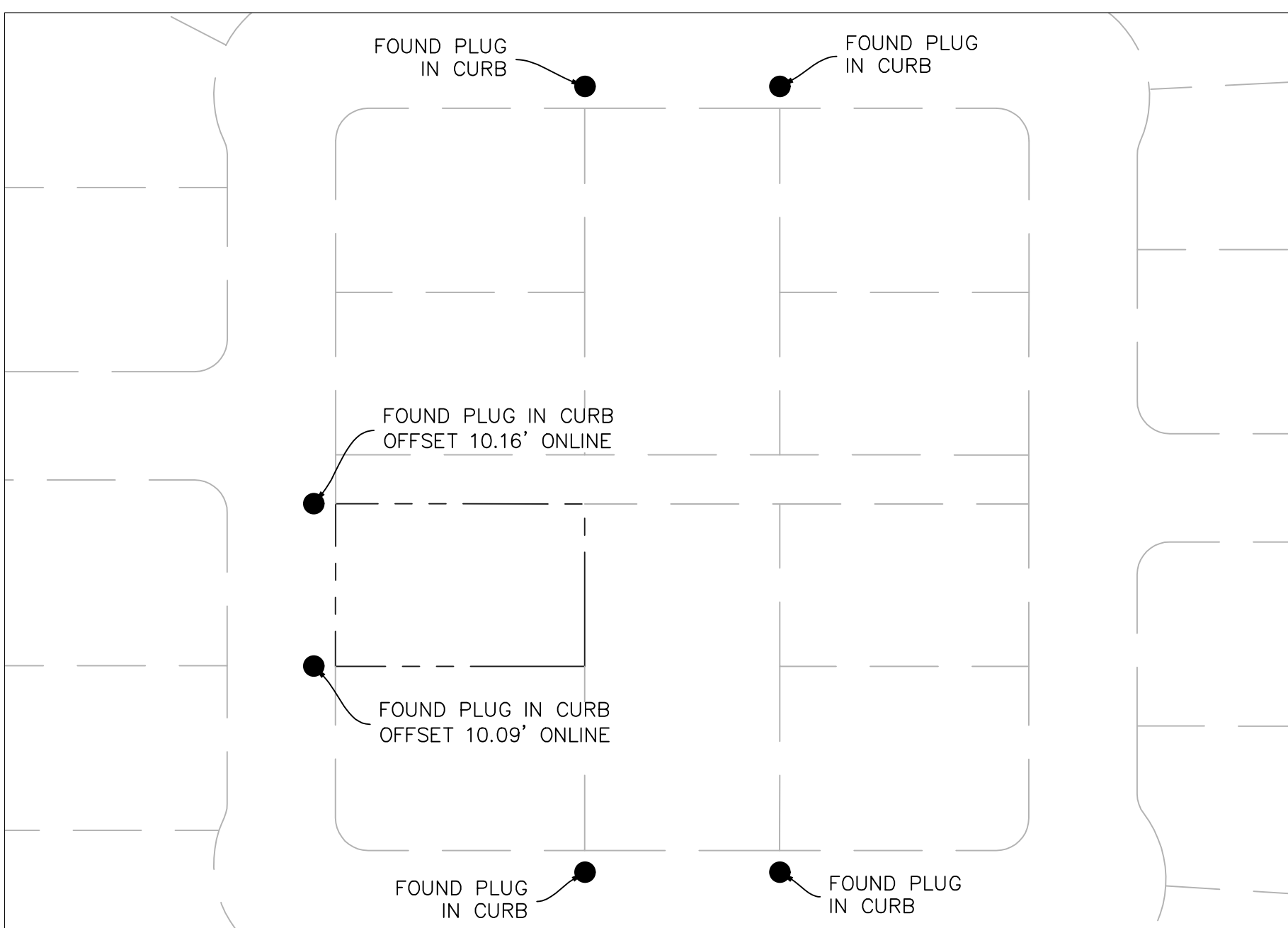

## PROJECT INFORMATION

# BOUNDARY SURVEY

REV.#	REVISION NOTES	DATE

CLIENT INFO
-------------



PROJECT NO.	Sheet
DATE	1
HORIZONTAL SCALE	1

1" = 10'



SCALE MEASURES 1-INCH ON FULL SIZE(36x24) SHEETS  
ADJUST ACCORDINGLY FOR REDUCED SIZE SHEETS.

